

VPH Series

■ Overview

The VPH Series High Temperature Melt Pressure transducer/transmitters are widely used in the plastics, chemical fiber, rubber, boiler industry high temperature melt pressure measurement and control. The product is digested and absorbed domestic and foreign similar products technology, uses the high-quality sensors and components meticulous production, with a stable and reliable performance, high accuracy, good dynamic, small temperature drift, high temperature resistance, etc. Can match our smart meter VM201, VM202, VM302 supporting the use, consisting of high-reliability, high-temperature melt pressure measurement and control system.

Do not need any changes, can directly match the produce such as Italy JEFTRAN, American DYNISCO.

■ Specifications

Items	Standard	Plus
Pressure range	0~3.5, 5, 10, 15, 20, 25, 30, 35, 40, 50, 60, 70, 80, 100, 150MPa	
Accuracy	±0.5%FS, 1.0%FS, 1.5FS	±0.1%FS, ±0.2%FS, ±0.3FS,
Repeatability	±0.3%FS, ±0.5%FS,	±0.1%FS, ±0.2%FS,
Input/Output impedance	350±10%FS Ω	350±5%FS Ω
Output sensitivity	1.5, 2, 3.3 mV/V ±2%	2, 2.5, 3.3 mV/V ±2%
Zero output	≤ ±10%FS	≤ ±5%FS
Bridge excitation voltage input	6, 10, 12V(Max.)	
Insulation Impedance	500MΩ@100V	
Calibrating point	80±2%	80±1%
Allowed Temperature	80°C for Senor wiring connector, 400°C for probe(Max. 535°C by custom)	
Temperature drift	±0.05%FS/°C	±0.02%FS/°C
Probe zero drift	≤ 0.3 MPa/100°C	≤ 0.1 MPa/100°C
Maximum fixing torque	100 Nm	
Mebrane material	1Cr18Ni9Ti	316L
Connecting thread	M14x1.5, 1/2"-20UNF, M18x1.5, M22x1.5, M28x1.5, G3/4"	

VPH Series

■ Mechanical Specifications

D1	M12x1.5	M14x1.5	1/2"-20	M18x1.5	M22x1.5	M28x1.5	G3/4"	PF3/8"	1 1/2"-16"	3.25"	3.5"
D2	Ø7.8	Ø7.8	Ø7.8	Ø10	Ø10/Ø16	Ø18	Ø18	Ø10	Ø23.5	Ø23.5	Ø23.5
D3	Ø10.2	Ø11.8	Ø10.5	Ø15.5	Ø19.5	Ø24	Ø24	Ø14	Ø33.5	Ø33	Ø33
D4	Ø10	Ø12	Ø10.5	Ø16	Ø19	Ø26	Ø24	Ø14.5			
D5		Ø14	Ø12.7	Ø18							
A	5.5	5.5	5.5	6	10	11	11	8	13	13.5	13.5
B	11	11	11	12	15.8	17	17	12	21	51	61
C	16	16	16	18	30	28	28	30	37	19	19
L1	70, 150, 250 optional										
L2	300, 470, 700, 1000, 2000, 3000 optional										
Sealing	45° inclined plane			Flat plane				Flange mounting			

Note: D1=Ø3.25" and Ø3.5" are the flange dimension

VPH111 Rigid Stem type pressure Transducer: Easy to install, used for measuring plastic, rubber etc. melt pressure. Connecting thread type any.

VPH111B Rigid Stem type pressure Transmitter: It is VPH111 for transmitter type.

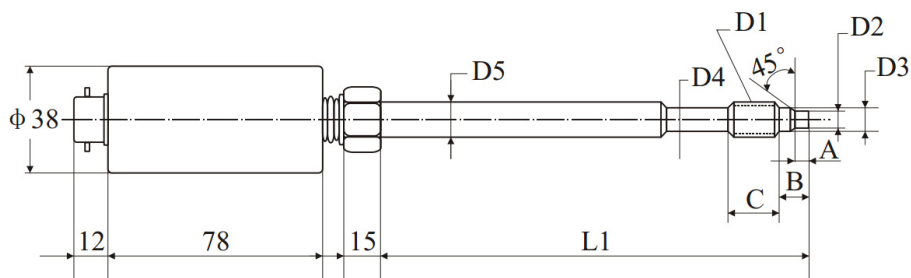

VPH123 Flexible Stem type pressure Transducer: Connecting thread 1/2"-20(or any);

VPH123B Flexible Stem type pressure Transmitter: It is VPH123 for transmitter type;

VPH124 Flexible Stem type pressure Transducer: Connecting thread M14x1.5(or any);

VPH124B Flexible Stem type pressure Transmitter: It is VPH124 for transmitter type;

VPH128 Flexible Stem type pressure Transducer: Connecting thread M18x1.5(or any);

VPH128B Flexible Stem type pressure Transmitter: It is VPH128 for transmitter type;

Between the shell and rigid detection rod is a stainless steel hose which can takes the sensor head and the transmitter circuit far away from the high temperature zone, in order to ensure the accuracy of the measurement, and also make the installation more flexible. Suitable for measuring high melting point plastics, chemical fiber and thicker insulation layer melt pressure, high-pressure steam, etc.

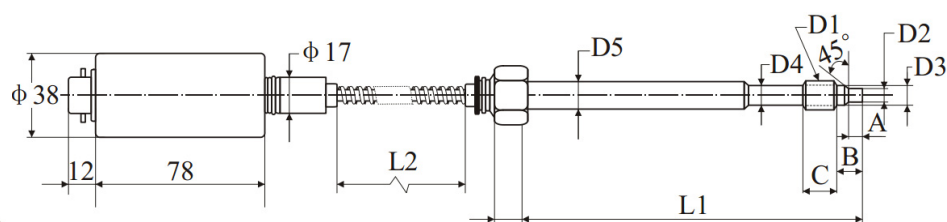

VPH Series

VPH131 Pressure & Temperature Dual ability type Transducer: Measuring a point pressure and temperature simultaneously; pressure measuring same as VPH123, connect thread type any.

VPH131B Pressure&Temperature Dual ability type Transmitter:It is VPH131 for transmitter type.

Can simultaneously measure the temperature and pressure in a same fixing channel, the pressure part of the performance and the technical requirements are the same as with VPH123. Temperature sensor is J, K, E thermocouple, or Pt100 heat resistance, using a two-Pins plug connection

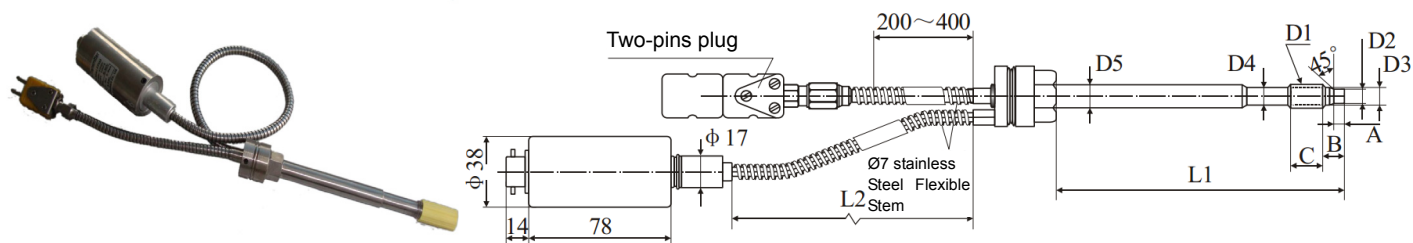

VPH125 Flexible Stem type pressure Transducer: Can replace the similar produce from Geman and Japan. Connecting thread M28x1.5(or any);

VPH125B Flexible Stem type pressure Transmitter: It is VPH125 for transmitter type;

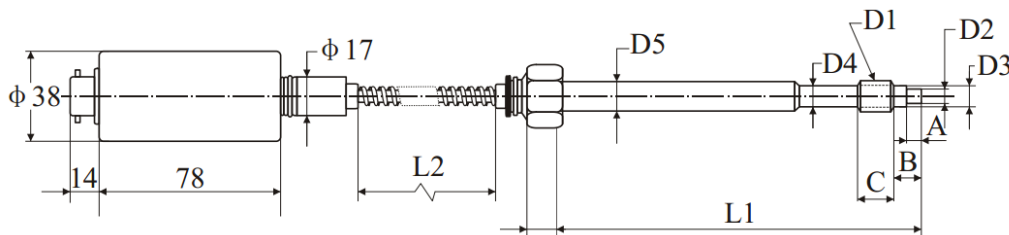

VPH127 Flexible Stem type pressure Transducer: Connecting thread M22x1.5(or any), other same as VPH124

VPH127B Flexible Stem type pressure Transmitter: It is VPH127 for transmitter type;

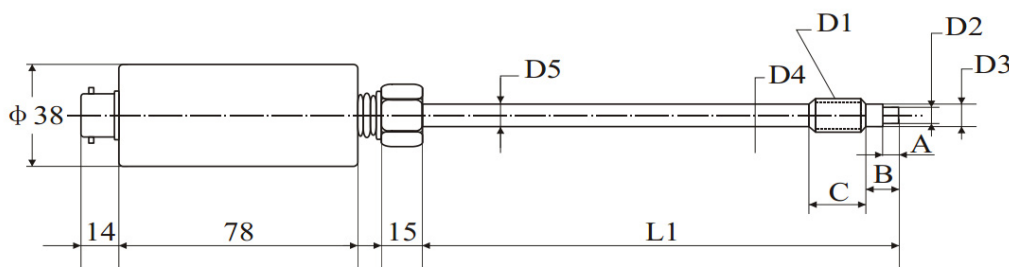

VPH132 Die cavity type pressure Transducer: Use for various die cavity pressure measuring and control, connecting thread any.

VPH132B Die cavity type pressure Transmitter: It is VPH132 for transmitter type;

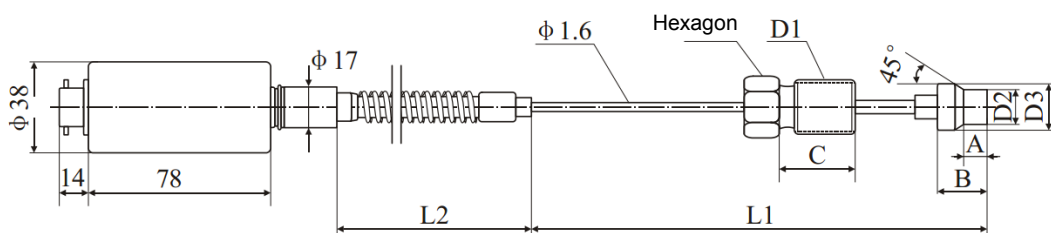

VPH Series

VPH135 High temperature pressure gauge: used for measuring plastic, rubber etc. melt pressure. Directly indicate the pressure value, Stable and reliable, easy to install.

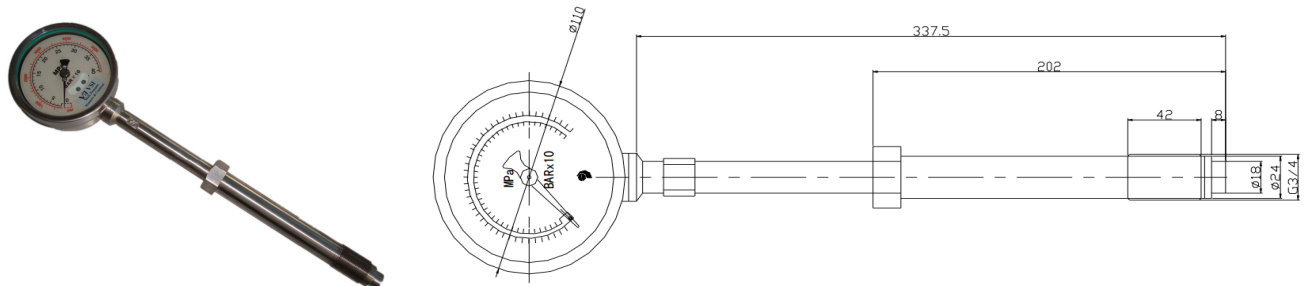

VPT-K/E/J High temperature and High pressure thermocouple: Widely used for high temperature and high pressure environment measuring such as plastic, rubber and chemical fiber field etc. High accuracy, Stable and reliable, easy to install.

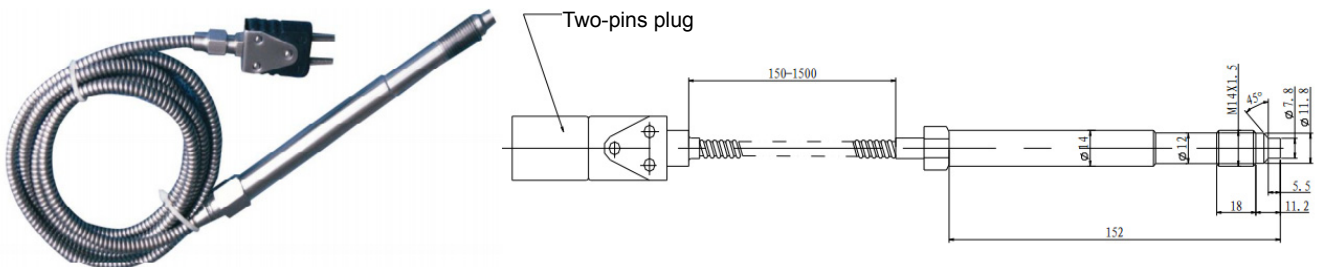

■ Wiring

Pressure Transducer wiring diagram

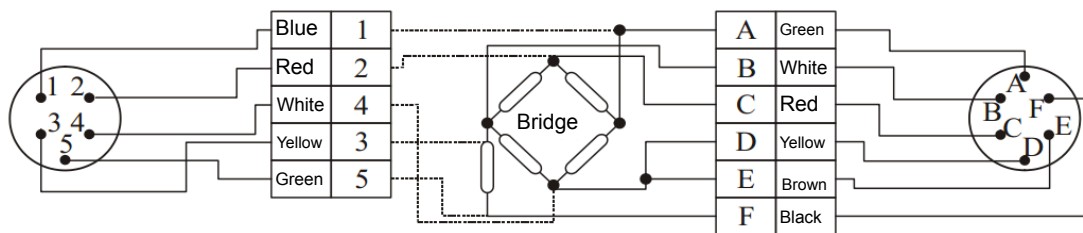

Standard DIN 5 pins connector wiring(Type I)

- 1-Output signal(+); 2-Power supply(+)
- 3-Output signal(-); 4-Power supply(-)
- 5- 80%FS calibration

Plus 6 pins connector wiring(type II)

- A-Output signal(+); B-Power supply(+)
- C-Output signal(-); D-Power supply(-)
- E,F- 80%FS calibration

VPH Series

Pressure Transmitter wiring diagram

Out put Model	Pin No.	Cable colour	Wiring
4-20mA 2 wires wiring	Transmitter A(type II) 1(type I)	Red	Power 24V +
		Red	
	B(type II) 3(type I)	Green	Output
		Blue	
	E(type II) 4(type I) F(type II) 5(type I)	Yellow	E- 80%F.S calibration
		Yellow	
Brown			
	Green	CAL	

Out put Model	Pin No.	Cable colour	Wiring
1-5V 0-5V 0-10V 0-20mA 4-20mA 3 wires wiring	Transmitter B(type II) 2(type I)	Red	Power 24V +
		Red	
	A(type II) 1(type I)	Green	Output(+)
		Blue	
	B,D(type II) 3(type I)	White,Black	0V
		Black	
E(type II) 4(type I) F(type II) 5(type I)	Yellow	E- 80%F.S calibration	
	Yellow		
	Brown		
	Green	CAL	

Out put Model	Pin No.	Cable colour	Wiring
1-5V 0-5V 0-10V 0-20mA 4-20mA 4 wires wiring	Transmitter C(type II) 2(type I)	Red	Power 24V +
		Red	
	A(type II) 1(type I)	Green	Output(+)
		Blue	
	B(type II) 3(type I)	White	Output(-)
		Black	
	D(type II) 4(type I)	Black	0V
		Yellow	
E(type II) 4(type I) F(type II) 5(type I)	Yellow	E- 80%F.S calibration	
	Yellow		
	Brown		
	Green	CAL	

